

# PVC PANELLING

for suspended ceiling or exposed roofing framework

## Installation instructions

Easy to work with and lightweight,  
**CABEX** panelling is available in 2  
versions :

- **Standard** for installation in horizontal or sloped suspended ceiling
- **Reinforced** for installation in exposed framework

It is installed by interlocking.

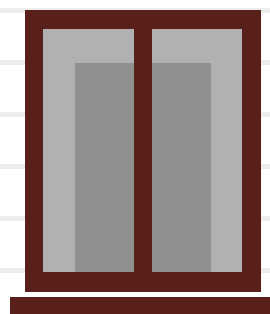

*An elevated view of the ceiling !*

# SMOOTH SUSPENDED CEILING INSTALLATION

horizontal or sloped

## TIPS

We recommend using our **STANDARD** panelling model for this type of installation.

- Anticipate **the direction** in which panels are to be installed :
  - Battens must be **perpendicular** to the panelling,
  - Battens should be spaced no more than 50 cm apart.
- Try the **UCLIP** profile (clip-on U) which makes it easier to fit the last panel.
- Remember **to clean the panels** regularly with a clean damp cloth.

The advice contained in this sheet can in no way replace the expertise by a design office.

## TOOLS AND SUPPLIES

- Tape measure
- Pencil
- Square
- Laser or bubble level
- Combined drill screwdriver
- Mini-circular saw
- Wood screws Ø 3.5 mm x 25 mm (or steel screws if metal rails)
- Cloth



## PVC PROFILES AND ACCESSORIES

- Clip-on U (**UCLIP**)
- Starting U strip
- Outgoing corner
- Incoming corner
- Moulding
- Variable angle
- H Junction

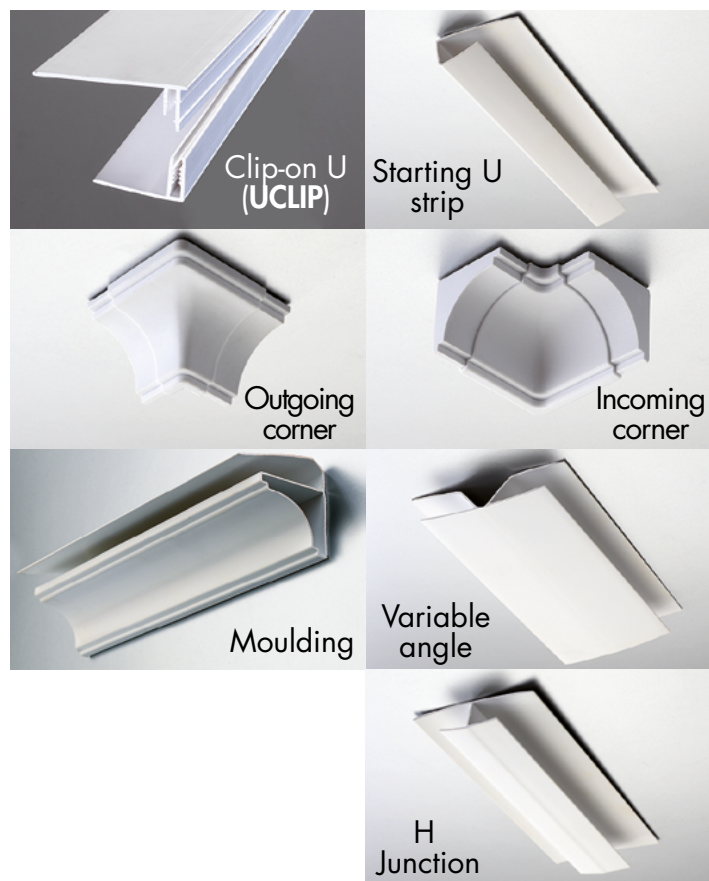

## Step 1

# SUSPENDED FRAMEWORK

Start by making a **perfectly** flat framework: :

- with **wooden slats** (e.g. 30 x 40 mm),
- with **metal rails**.

This framework will serve as a support for fixing PVC profile sections (spacing of **50 cm** maximum).

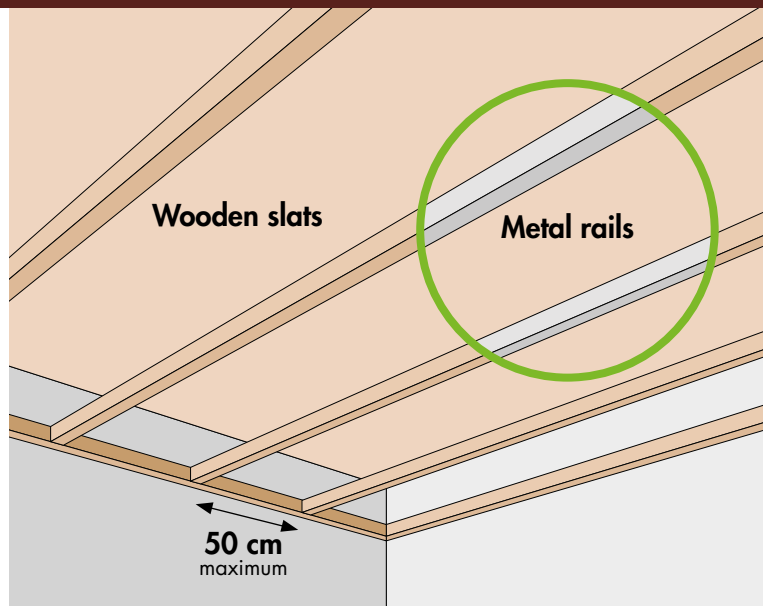

## Step 2

# FRAMEWORK

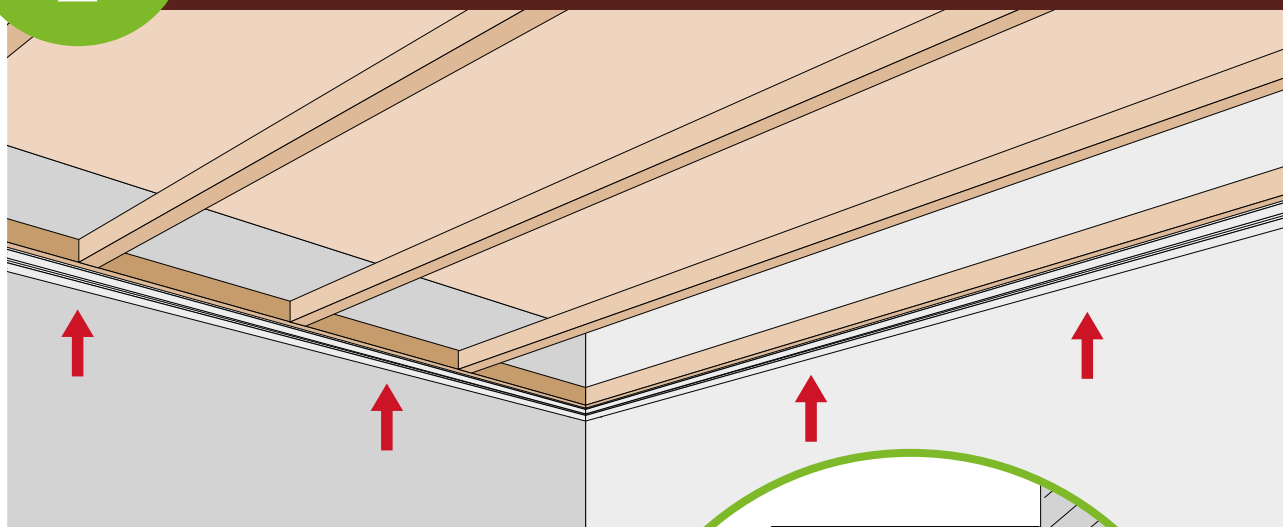

Then fix the **retaining PVC profile** sections (type starting **U strip**) on the wooden frame around the room.

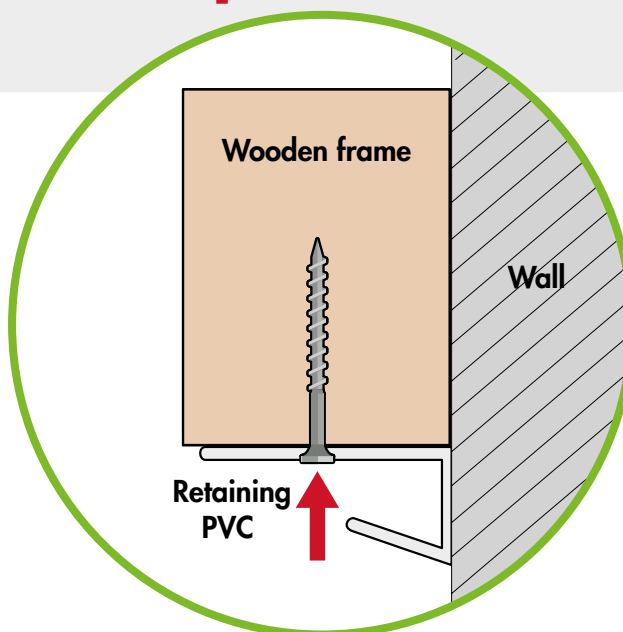

## Step 3

# CUTTING

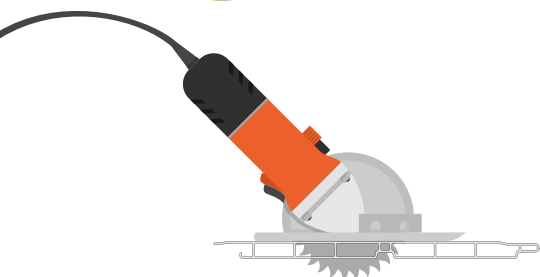

Cut the panels to the desired length one by one.

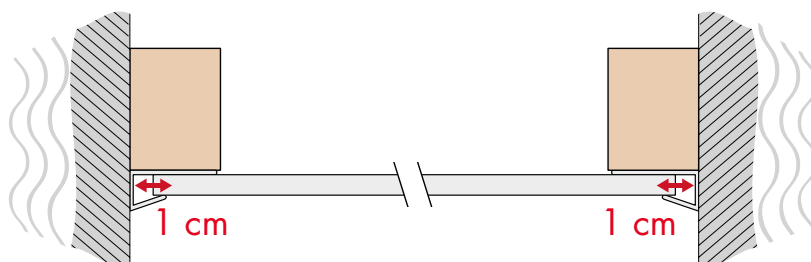

**Caution**, panel length must be less than the dimension measured between walls (between 2 and 3 cm less) to facilitate installation and prevent their breakage and fall in case of a **seismic event**.

## Step 4

# INSTALLATION

**RECOMMENDATION**  
Clean the panels regularly with a clean damp cloth

Insert the ends of each panel into the **retaining PVC profile section** (type starting **U strip** or type **clip-on U**)

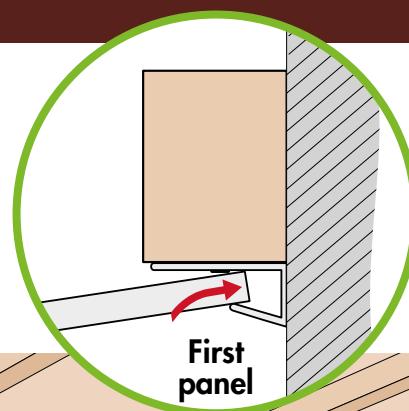

Then slide each panel to **insert** it into the profile section (for the first panel) or to the previous one (for the following panels).

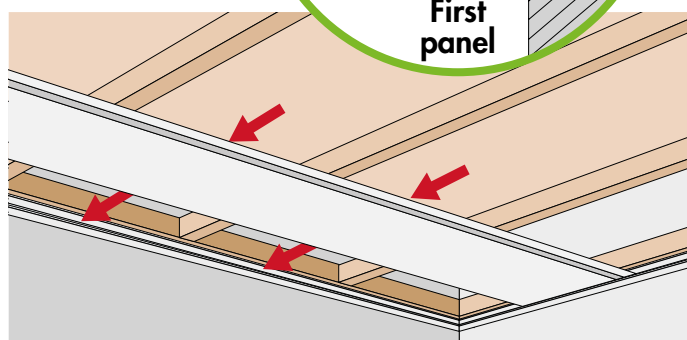

Fix the panel with **screws Ø 3.5 mm x 25 mm** in its wide flap at the **crossing** of each wooden slat (or metal rail). Screws are hidden by the next panel.

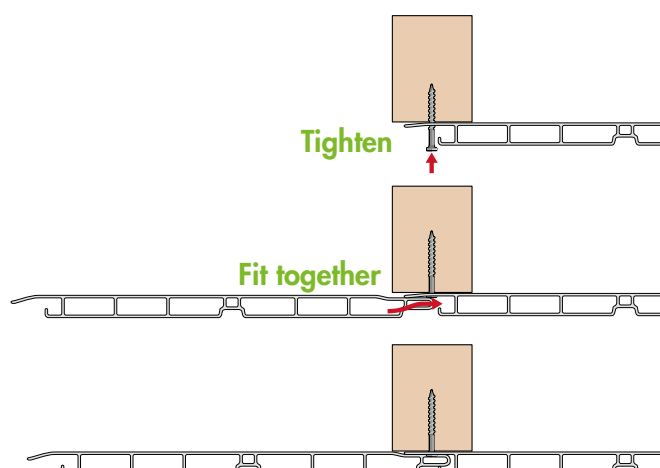
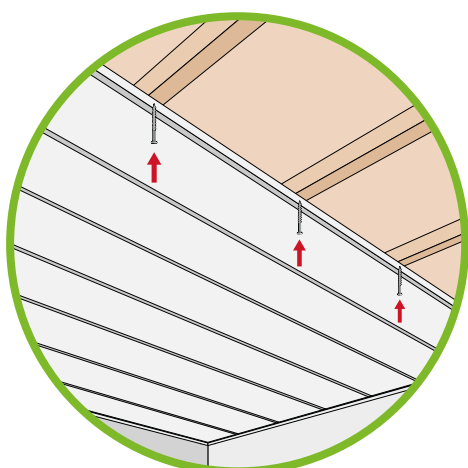

## Step 5

# LIGHT SPOT(S)

To install **a light spot**, drill a hole where it should be placed on the panel and pass the electrical cable left by the electrician.

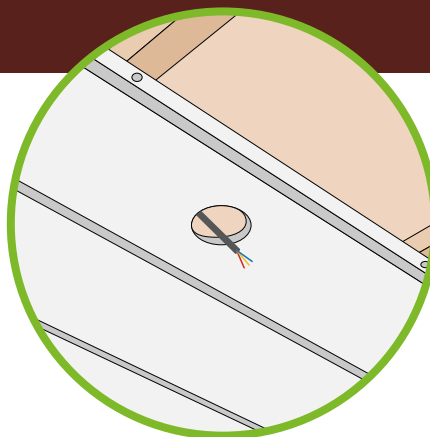

### Suspended lighting

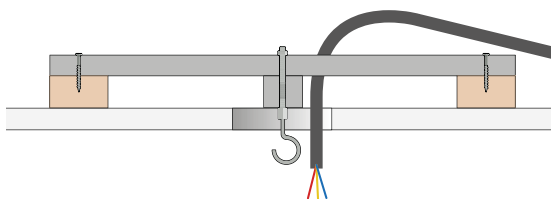

For heavy **suspended lighting** (type **chandelier**), it is recommended to fix this heavy element to the suspended ceiling's load-bearing structure with an adapted crosspiece, or even to the framework of the roof above..

### Integrated lighting

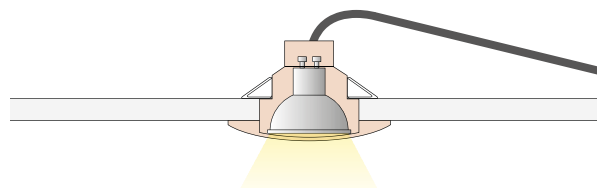

For **integrated lighting** (**spot** type), its weight shall not be over 2 Kg. The maximum electrical load is 20 W.



## Step 6

# THE LAST PANEL

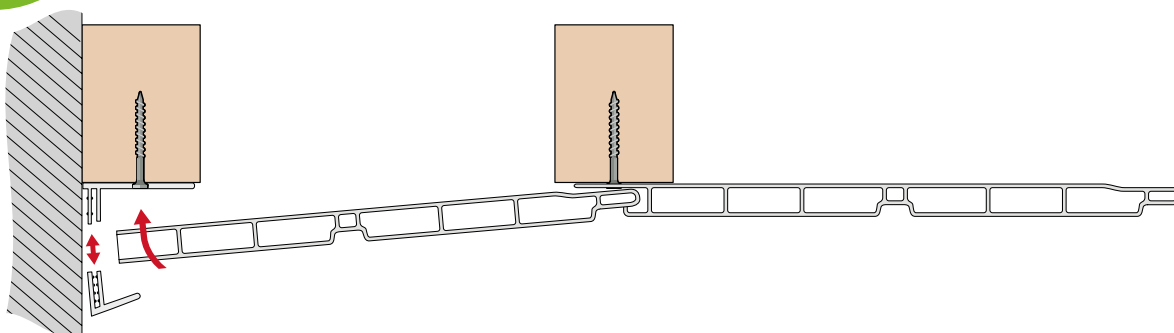

Adjust and cut **the last panel lengthwise** to fit the distance (minus 1 cm) between your retaining profile section bottom (**UCLIP** for example) and the second-to-last panel, fit them together, then close the **UCLIP**.

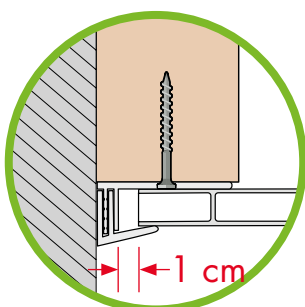

Your suspended ceiling in Cabex PVC panelling is now finished!



# EXPOSED ROOFING FRAMEWORK INSTALLATION

## TIPS

We recommend the use of our **REINFORCED** panelling model for this type of installation.

- **The distance between rafters** must not exceed **60 cm** (centre-to-centre distance).
- The installation of thermal and/or sound insulation between the roof covering and the PVC ceiling is recommended.
- Ventilation grids allow air circulation in order to prevent moisture.
- Remember to **clean the panelling regularly** with a clean damp cloth.
- Do not allow the frame to get wet before and during the work.

The advice contained in this sheet can in no way replace the expertise by a design office.

## TOOLS AND SUPPLIES

- Tape measure
- Pencil
- Cordex, level, ...
- Mini-circular saw
- Hammer
- Galvanised large-headed nails at least 25 mm long
- Cloth



## Step 1

## INSTALLING THE FIRST PANEL

Install the **first panel** from above the roof structure, starting on either side of the slope.

Use galvanised, large-headed nails (25 mm minimum length) for fixing the panel, to be **hammered on the reverse side of the PVC panel**, in the middle of its width, where rafters cross..

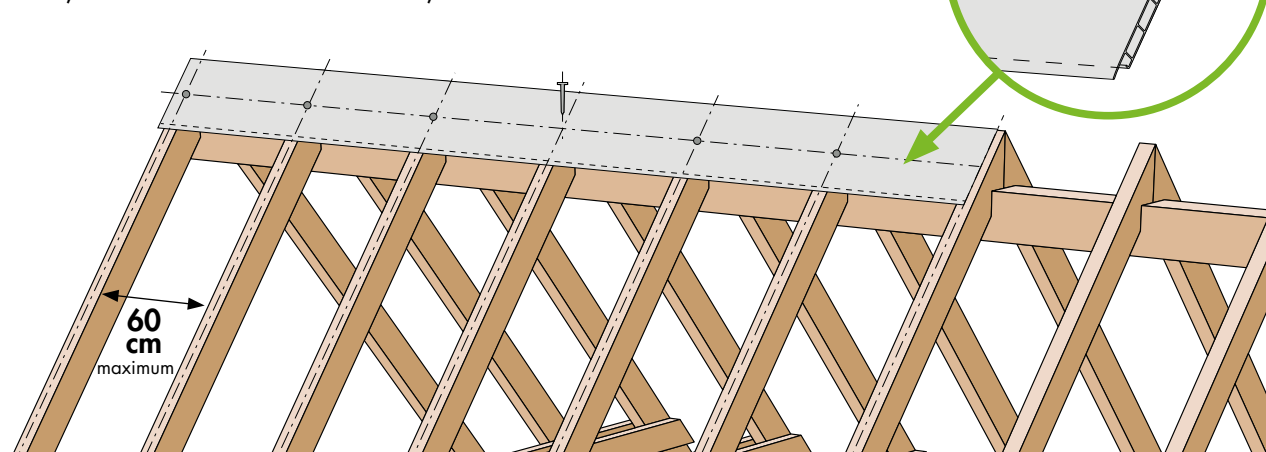



## Step 2

# FITTING THE OTHER PANELS

Proceed with the panelling installation:

- **by fitting** the panels properly one by one, into each other,
- **by fixing** them as you go.

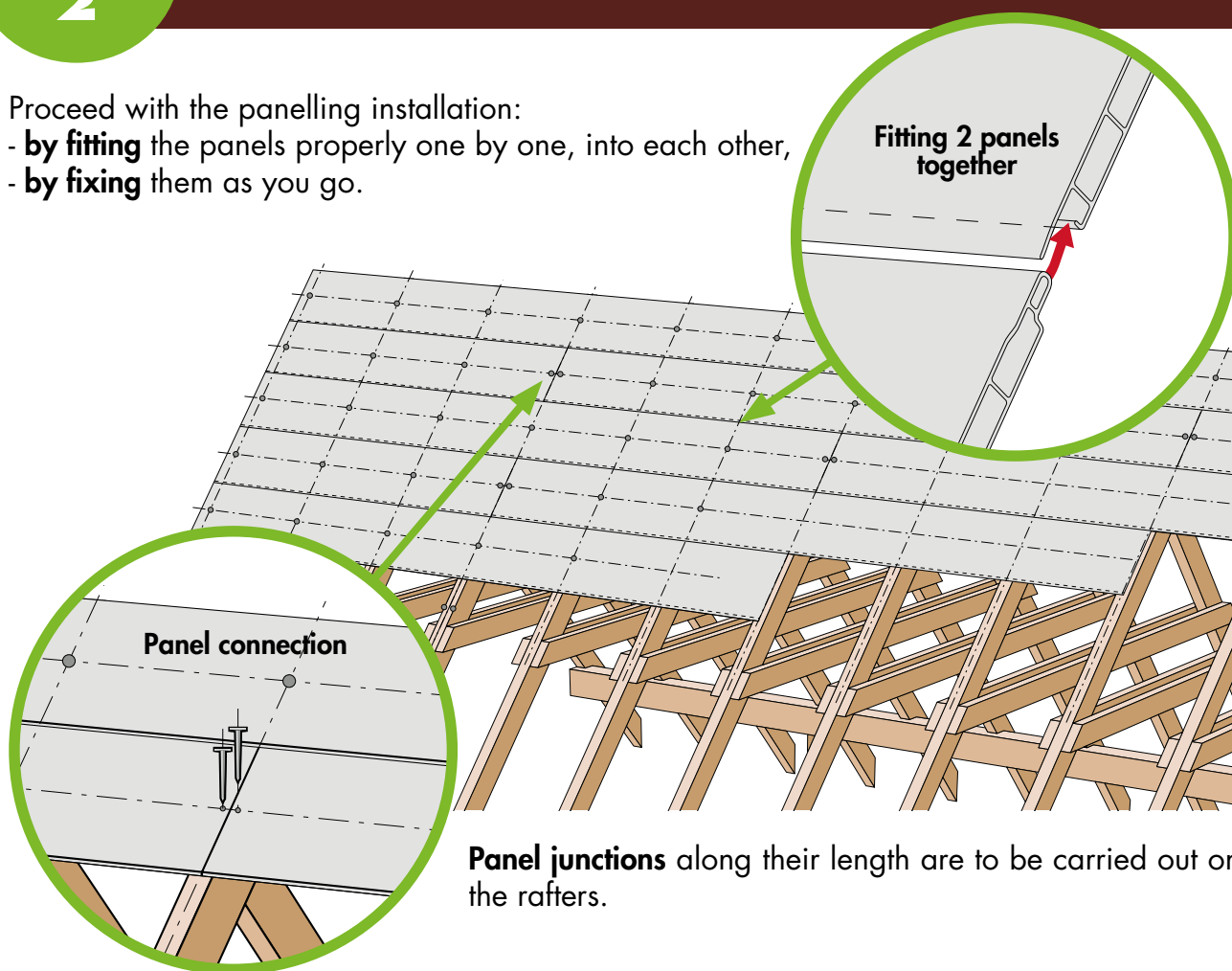

## Step 3

# INSTALLING THE COUNTER SLATS

Place **counter slats** perpendicular to the rafters.

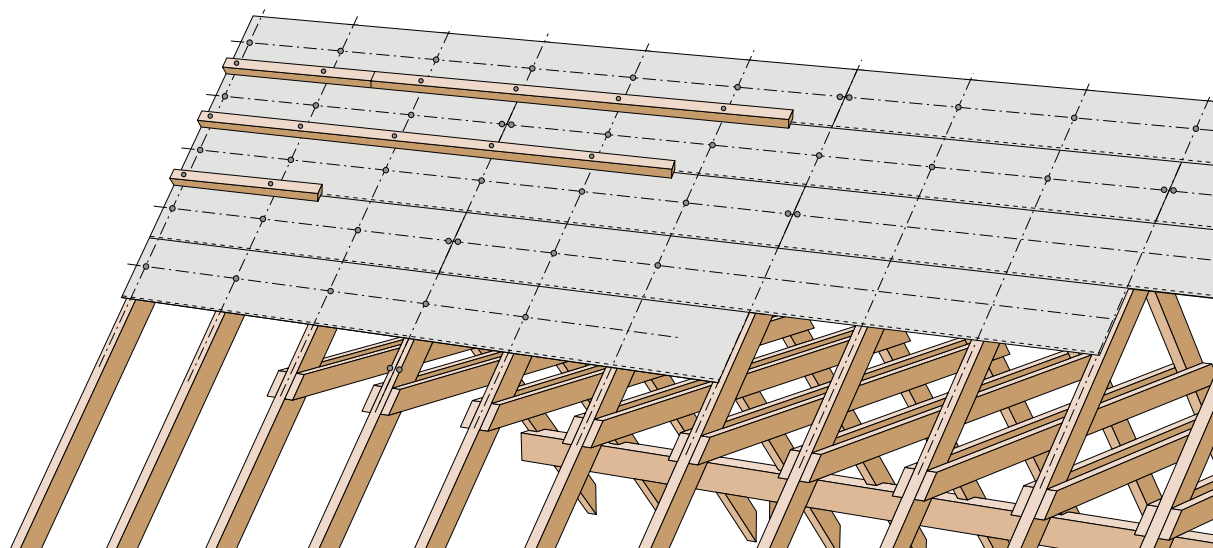

# Step 4

## LIGHT SPOT(S)

To install a **light spot**, drill a hole where it should be placed on the panel and pass the electrical cable left by the electrician.

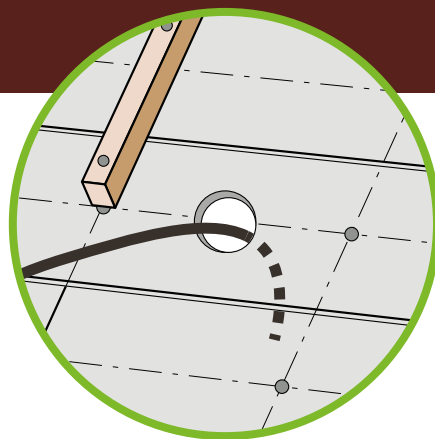

### Suspended lighting

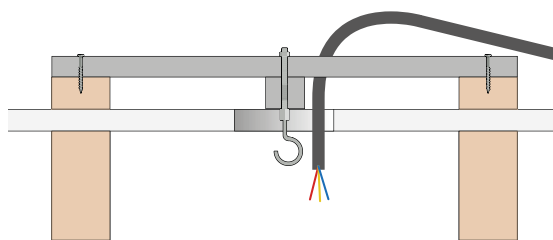

For **heavy suspended lighting** (type **chandelier**), it is recommended to fix this heavy element to the suspended ceiling's load-bearing structure with an adapted crosspiece, or even to the framework of the roof above.

### Integrated lighting

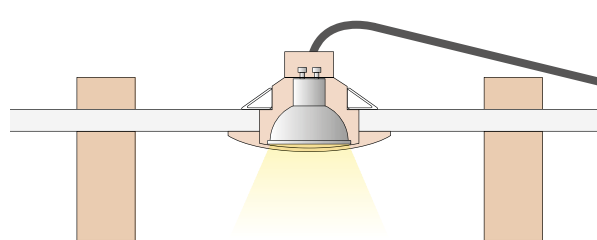

For **integrated lighting** (type **spot**), its weight shall not be over 2 Kg. The maximum electrical load is 20 W.



**CABEX** is a wide range of PVC panelling.

- Standard or reinforced,
- Length 6 m, width 13 or 26 cm.



Our panelling is manufactured in Martinique and Guadeloupe and available at many retailers in the French West Indies.



[www.cabex-antilles.fr](http://www.cabex-antilles.fr)

# CABEX

### MARTINIQUE

ZI Pelletier  
97232 LE LAMENTIN  
Tel: +590 596 571 023  
Fax: +590 596 515 307

### GUADELOUPE

ZI Jarry - 651 Rue de la Chapelle  
97122 BAIE MAHAULT  
Tel: +590 590 381 414  
Fax: +590 590 327 733

### FRENCH GUIANA

15 LOT. ZI COLLERY III  
97300 CAYENNE  
Tel: +590 594 257 494  
Fax: +590 594 376 263